

6

5

4

3

2

1

MATERIAL AND FINISH:

Insulator: Polycarbonate, UL-94V-0 rated

Contacts: Brass, Nickel plated

ELECTRICAL SPECIFICATIONS:

Current rating: 10 A

Voltage rating: 250 VAC

Current rating: 15 A

Voltage rating: 250 VAC

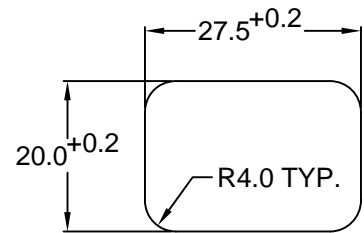
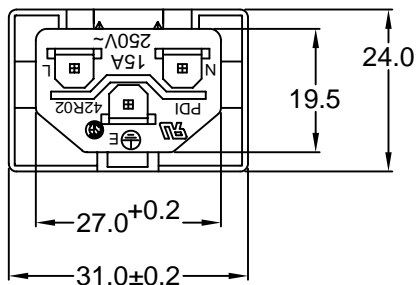

RECOMMENDED
PANEL CUTOUT

ORDERING CODE:

42R02-3 - - - -
1 2 3 4

1 = TERMINAL OPTIONS

1 = .187(4.8) (NOT TOOLED)

2 = .250(6.3)

2 = COLOR

1 = BLACK

2 = GRAY

**3 = ELECTRICAL CIRCUIT
CONFIGURATION**

1 = 15A 250V 120°C
2+GROUND



2 = 15A 250V 70°C
2+GROUND



4 = 15A 250V 70°C
2 POLE



4 = PANEL THICKNESS

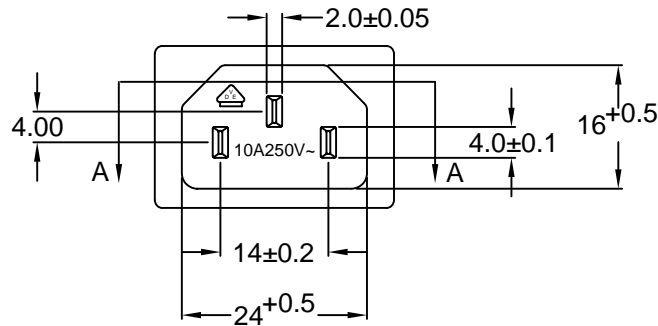
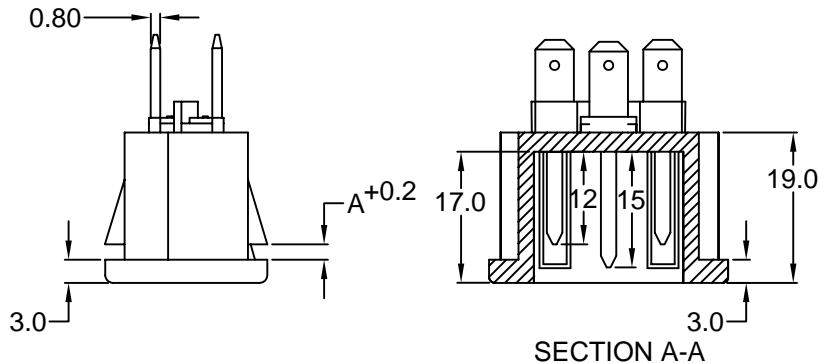
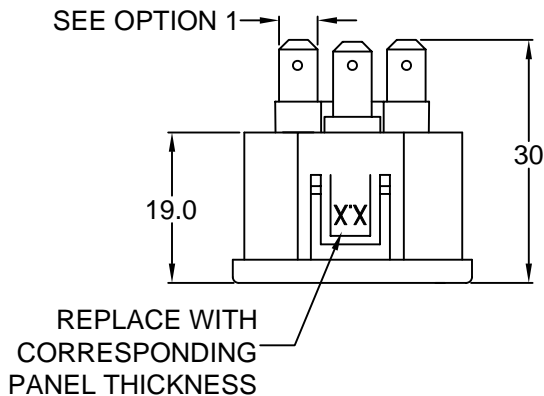

P/N	A	MAX. PANEL THICKNESS
42R02-3XXX-100	1.0	1.0
42R02-3XXX-150	1.5	1.5
42R02-3XXX-200	2.0	2.0
42R02-3XXX-250	2.5	2.5

ADDITIONAL PANEL THICKNESS
AVAILABLE ON REQUEST

REV	DATE	CHANGE	CHNG CHECK APPR	
			TD	PB
A	9/02/04	REVISED & UPDATED		
B	3/3/09	ADD 1.0mm SNAP IN TAB		

TOLERANCE
UNLESS OTHERWISE SPECIFIED
X ± 1
X.X ± 0.4
X.XX ± 0.20

**RoHS
COMPLIANT**

DRAWN BY: GQ DATE: 8/2/01
CHECK BY: TD DATE: 08/14/01
APPR BY: PB DATE: 08/14/01

Power Dynamics, Inc.
Phone: 973 560-0019 Whippany, New Jersey Fax: 973 560-0076

PART: IEC 60320 CONNECTOR; QUICK
CONNECT INLET; SNAP-IN

PART #: **42R02-3XXX-XXX** SHEET 1 of 1
SIZE: A ALL DIMENSIONS FOR REFERENCE ONLY
SCALE: NTS DIMENSIONS ARE IN MILLIMETERS REV: B