

6

5

4

3

2

1

MATERIAL: CuZn, Silver plated

RoHS
COMPLIANT

ACCESSORIES:

CRIMP TOOL FOR CONTACTS:
P/N: PD-HEC-CT

POWER CONTACT EXTRACTION TOOL:
P/N: PD-HEC-PCET

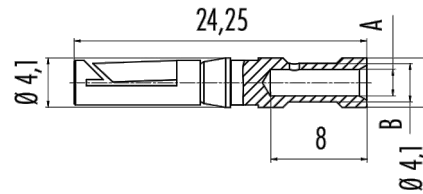
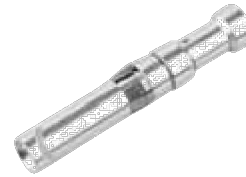

D

D

C

C

B

B

A

A

| | | | | |
|-----|------|------|-----|------|
| REV | DATE | CHNG | CHK | APPR |
| | | | | |

| P/N | AWG / mm ² | A | B |
|---------------|-----------------------|-----|-----|
| PD-HEC-FPC-14 | 14 / 2.5 | 2.2 | 3.2 |
| PD-HEC-FPC-16 | 16 / 1.5 | 1.8 | 3.0 |

| | |
|---|---------|
| TOLERANCE UNLESS OTHERWISE SPECIFIED | |
| X | ± 1 |
| X.X | ± 0.4 |
| X.XX | ± 0.13 |
| DRAWN BY | PB |
| DATE: | 7/28/14 |
| CHECK BY | |
| DATE: | |
| APPR BY | |
| DATE: | |

Power Dynamics, Inc.
 Phone: 973 560-0019 Whippany, New Jersey Fax: 973 560-0076

PART: HARSH ENVIRONMENT CONNECTOR
 FEMALE POWER CONTACT

PD-HEC-FPC-XX

SIZE: A
 SCALE: NTS

ALL DIMENSIONS FOR REFERENCE ONLY
 DIMENSIONS ARE IN MILLIMETERS

SHEET 1 of 1
 REV:

6

5

4

3

2

1