

CENTRONICS CONNECTORS

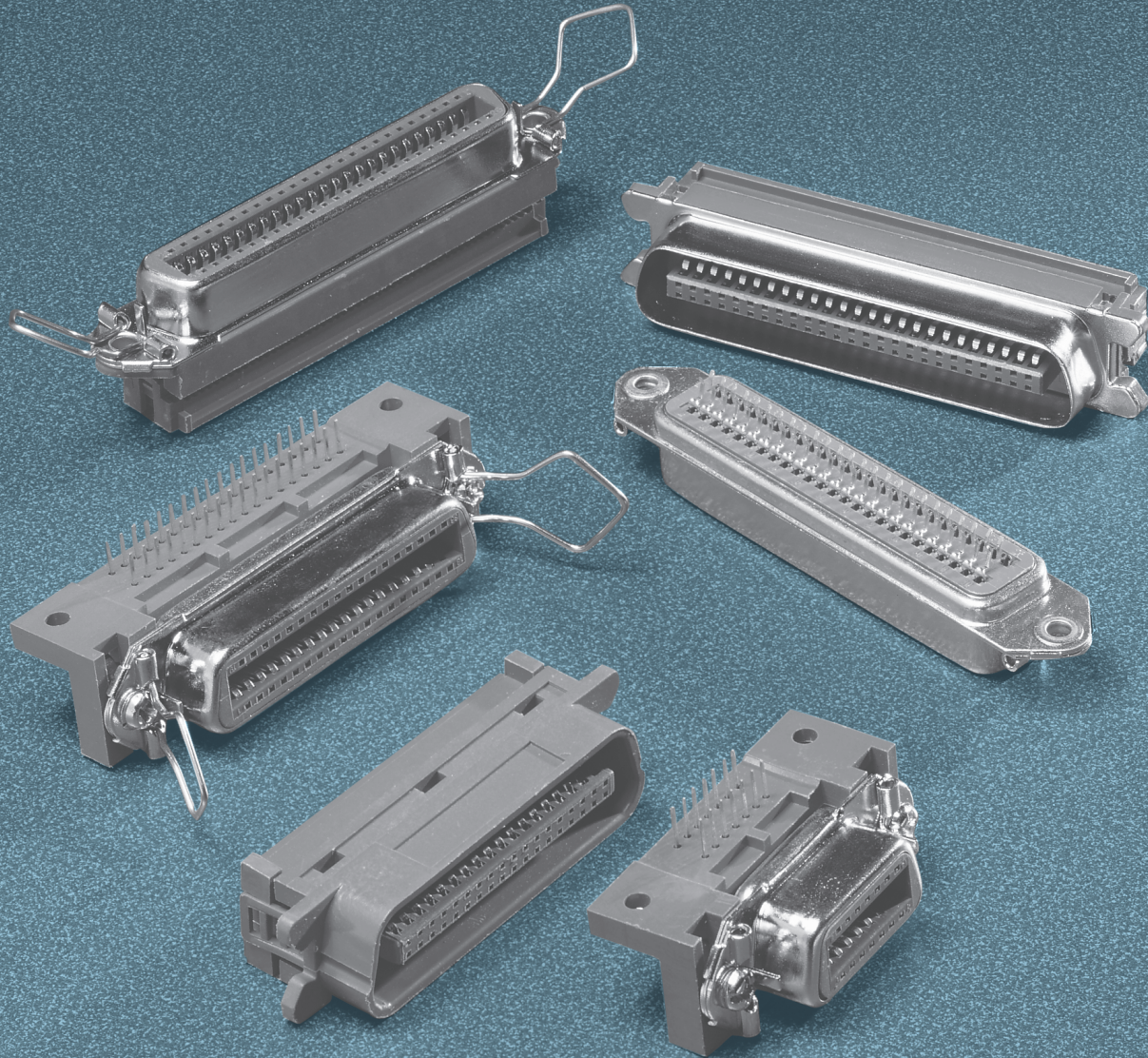

Power Dynamics shielded and unshielded Centronic connectors offer low cost cable-to-board and board-to-board connections. They are available in 14, 24, 36, and 50 contacts. Termination types include P.C.B., solder cup, and I.D.C. They can be used in a wide variety of computer and data interface applications. All PDI Centronic connectors carry the  and  safety approvals.



PDI[®]
Power Dynamics, Inc.

EXAMPLE & ORDERING CODE

PC **I** - **36** **R** - **B** - **L** **T**

CONNECTOR TYPE:

UNFILTERED, SHIELDED = I
(METAL FACE)
UNFILTERED, UNSHIELDED = U
(PLASTIC FACE)

NUMBER OF PINS:

= 14
= 24
= 36
= 50

GENDER:

MALE = S
FEMALE = R

PIN TYPE:

RIGHT ANGLE = BLANK
STRAIGHT = S

TERMINATION TYPE:

P.C. PINS = BLANK
SOLDER CUP = S
I.D.C. = I

MATING FACE:

HOLE (STRAIGHT ONLY) = H
LATCH (FEMALE ONLY) = L
NOTCHED FLANGE = N
SCREW = U

P.C.B. FACE (RIGHT ANGLE ONLY):

BOARD LOCK = BLANK
HOLE = H
THREADED HOLE = T

SPECIFICATIONS

MATERIAL AND FINISH:

Shell:

Material: Steel
Plating: Tin

Contacts:

Material: Phosphor Bronze
Thickness: Gold Flash over Nickel

Insulator: PBT and Glass-fiber reinforced
UL 94V-0

ELECTRICAL SPECIFICATIONS

Rated Current: 1A

Insulator Resistance: 1000 Megaohm min. @
500 VDC

Dielectric Withstanding Strength: 1000 VAC
for 1 minute

Temperature: -55°C to 105°C



PDI[®]
Power Dynamics, Inc.

145 Algonquin Parkway, Whippany, NJ 07981 • 973-560-0019 • FAX: 973-560-0076
e-mail: sales@powerdynamics.com • www.powerdynamics.com

Straight, P.C. Pin, Shielded



PCI-36RS-B-L
(shown)

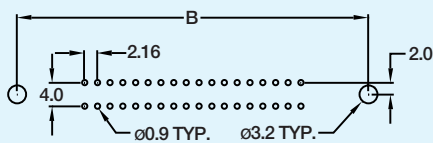
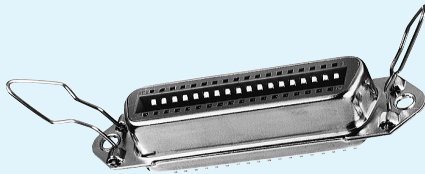

RECOMMENDED
PCB LAYOUT (TOP VIEW)

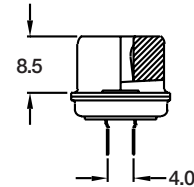
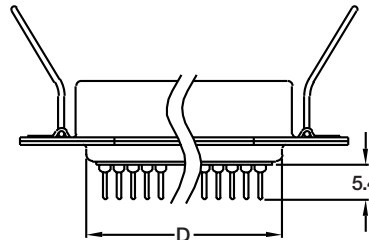
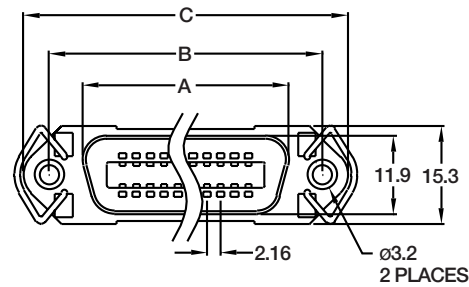

POSITION	A	B	C	D
14	25.20	36.00	43.90	22.70
24	36.00	46.80	54.70	33.50
36	48.90	59.70	67.70	46.60
50	64.10	74.90	82.80	61.70

PCI-36SS-B-H
(shown)

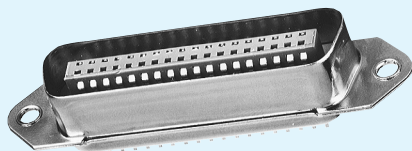

RECOMMENDED
PCB LAYOUT (TOP VIEW)

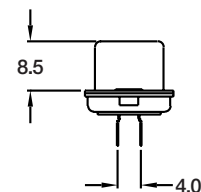
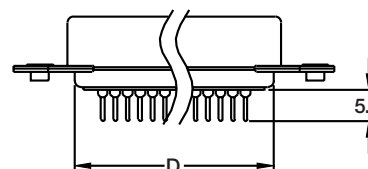
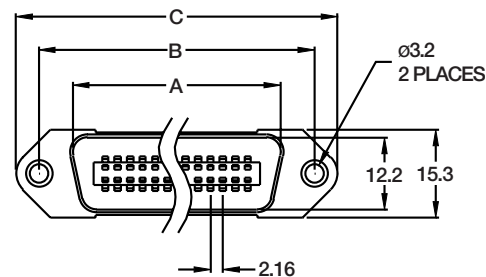

POSITION	A	B	C	D
14	25.50	36.00	43.90	22.70
24	36.30	46.80	54.70	33.50
36	49.30	59.70	67.70	46.60
50	64.40	74.90	82.80	61.70

Specifications subject to change without notice. Dimensions in mm.

Straight, Solder Cups, Shielded



PCI-36RS-SB-L
(shown)

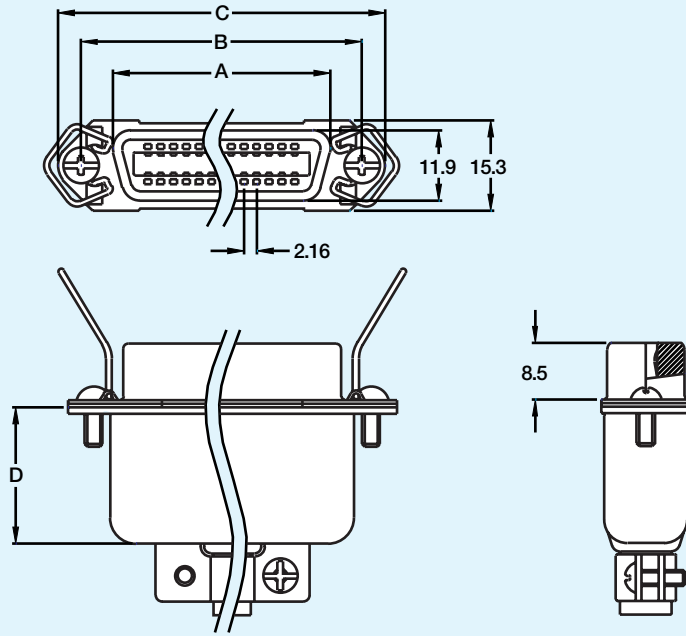

POSITION	A	B	C	D
14	25.20	36.00	43.90	21.70
24	36.00	46.80	54.70	21.20
36	48.90	59.70	67.70	23.00
50	64.10	74.90	82.80	25.00

PCI-36SS-SB-N
(shown)

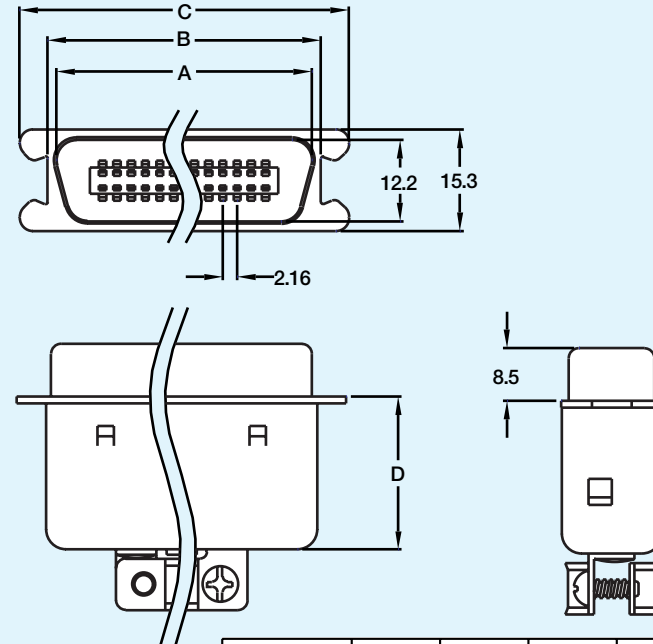
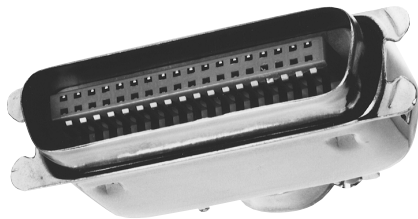

POSITION	A	B	C	D
14	26.70	29.70	38.00	21.10
24	38.20	40.50	48.80	21.10
36	50.80	53.50	61.70	22.60
50	64.40	68.70	77.00	24.60

Specifications subject to change without notice. Dimensions in mm.
Custom cables also available. See page 290.



145 Algonquin Parkway, Whippany, NJ 07981 • 973-560-0019 • FAX: 973-560-0076
e-mail: sales@powerdynamics.com • www.powerdynamics.com

Right Angle, P.C.B., Shielded



PCI-50R-B-LT
(shown)

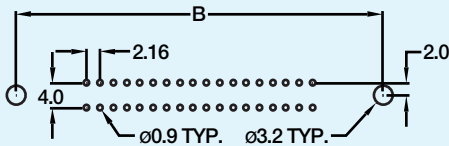
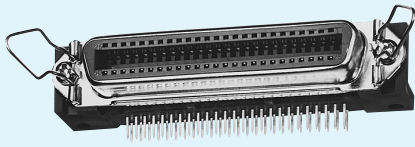

RECOMMENDED
PCB LAYOUT (TOP VIEW)

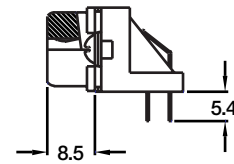
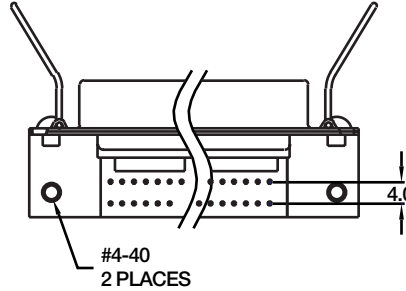
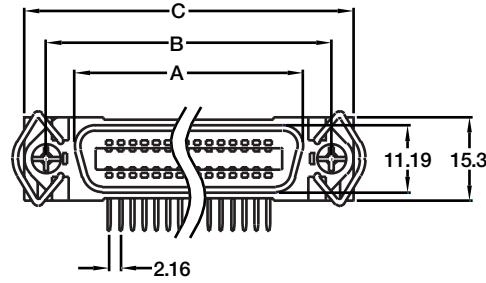

POSITION	A	B	C
14	25.20	36.00	43.90
24	36.00	46.80	54.70
36	48.90	59.70	67.70
50	64.10	74.90	82.80

PCI-50S-B-UT
(shown)

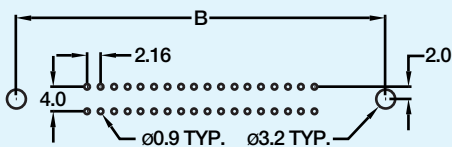
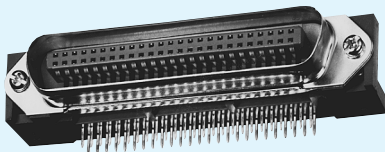

RECOMMENDED
PCB LAYOUT (TOP VIEW)

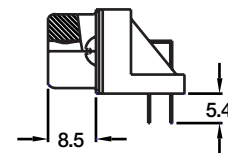
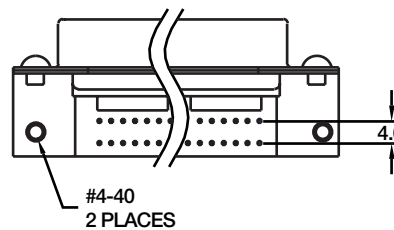
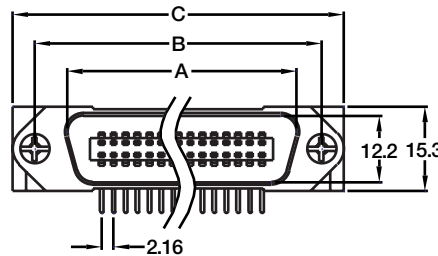

POSITION	A	B	C
14	25.50	36.00	43.90
24	36.30	46.80	54.70
36	49.30	59.70	67.70
50	64.40	74.90	82.80

Specifications subject to change without notice. Dimensions in mm.

I.D.C. Shielded and Unshielded



PCI-50RS-IB-L
(shown)

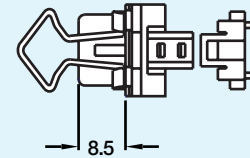
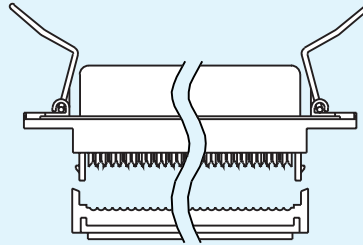
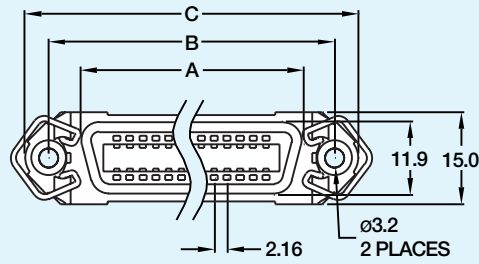
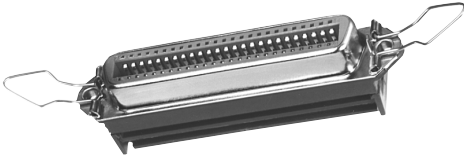

POSITION	A	B	C
36	48.40	59.70	67.90
50	63.80	74.90	82.90

PCU-50SS-IB-N
(shown)

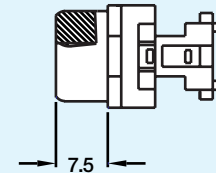
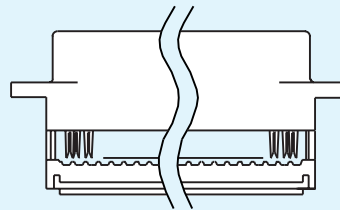
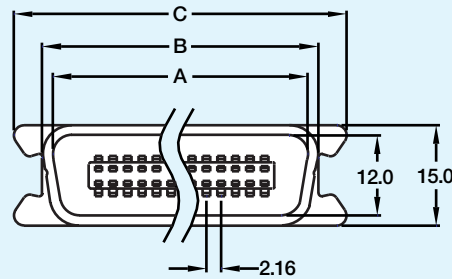
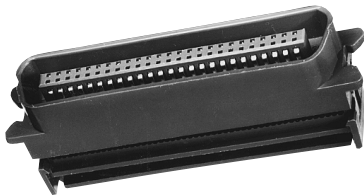

POSITION	A	B	C
36	49.00	52.60	61.50
50	64.40	69.30	76.60

Specifications subject to change without notice. Dimensions in mm.
Custom cables also available. See page 254.



145 Algonquin Parkway, Whippany, NJ 07981 • 973-560-0019 • FAX: 973-560-0076
e-mail: sales@powerdynamics.com • www.powerdynamics.com